

- NOTES:**
1. ALL WORKS TO BE CONSTRUCTED IN ACCORDANCE WITH THE NRA SPECIFICATION FOR ROAD WORKS UNLESS OVERRIDDEN BY LOCAL OVERSEEING AUTHORITY'S STANDARDS
 2. ALL ROAD MARKINGS & SIGNS SHALL COMPLY FULLY WITH THE TRAFFIC SIGNS MANUAL, PUBLISHED BY THE DEPARTMENT OF TRANSPORT, JUNE 2010.
 3. SIGNS & MARKINGS: CONTRACTOR TO CONFIRM PRECISE SETTING OUT WITH EMPLOYER'S REPRESENTATIVE PRIOR TO COMPLETION.
 4. ALL SIGNS TO BE MOUNTED ON 76.1mm GALVANISED STEEL POSTS WITH COLOURED SLEEVES U.N.O. TO SPECIFICATION AND IN ACCORDANCE WITH THE TRAFFIC SIGNS MANUAL; MOUNTING HEIGHT TO BOTTOM OF SIGN = 2.3m U.N.O.
 5. ALL TRAFFIC MANAGEMENT TO COMPLY FULLY WITH THE PROVISIONS OF CHAPTER 8 OF THE TRAFFIC SIGNS MANUAL
 6. ALL CO-ORDINATES ARE TO ITM.
 7. ALL LEVELS ARE TO ORDINANCE DATUM AND ARE IN METRES
 8. ALL EXISTING SIGNS (INCLUDING POLES) AND MARKINGS TO BE TAKEN UP OR COVERED AND TEMPORARY MEASURES APPLIED IN ACCORDANCE WITH CONTRACTOR'S TRAFFIC MANAGEMENT PLAN. THE CONTRACTOR MAY USE EXISTING SIGNAGE AS PART OF THEIR TRAFFIC MANAGEMENT PLAN.
 9. ALL EXISTING CHAMBERS AND ACCESS POINTS TO REMAIN CLEAR OF OBSTRUCTION THROUGHOUT WORKS. CHAMBERS SHALL BE REBUILT/RETAINED IN POSITION IDENTIFIED ON SITE SERVICES LAYOUT DRAWING.
 10. ALL PEDESTRIAN, CYCLE AND VEHICULAR ROUTES MUST BE RETAINED IN ACCORDANCE WITH APPROVED TRAFFIC MANAGEMENT PLAN.
 11. ALL MATERIALS TO BE DISPOSED OFF SITE SHALL BE TAKEN TO A LICENSED FACILITY APPROVED BY THE LOCAL OVERSEEING AUTHORITY

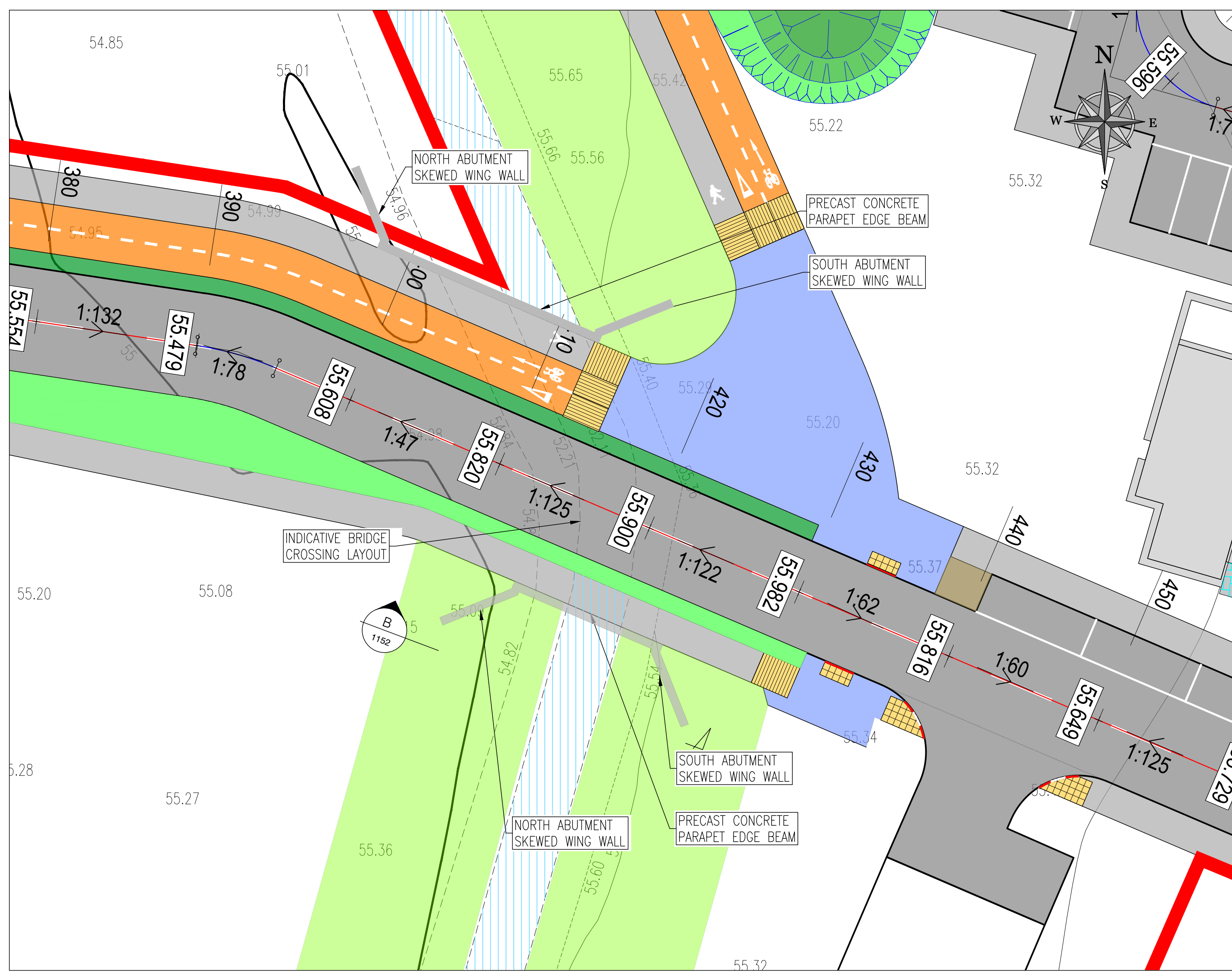
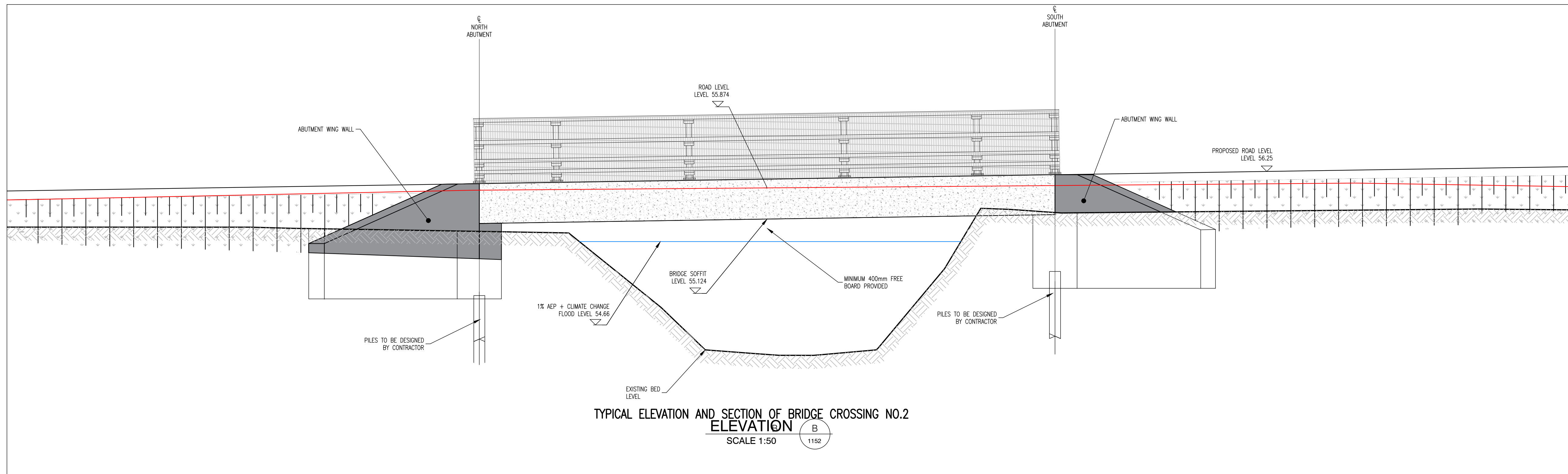

LEGEND:

- SITE BOUNDARY
- PROPOSED ROAD
- PROPOSED FOOTPATH
- PROPOSED BUILDING
- PROPOSED CYCLE PATH
- PROPOSED SHARED PATH
- PROPOSED VERGE
- PROPOSED PERMEABLE PAVING
- ↘ 1:999 PROPOSED ROAD GRADIENT
- 99.99 PROPOSED ROAD LEVELS
- FFL 55.500 PROPOSED FINISHED FLOOR LEVELS
- PROPOSED BUILDING STEPS
- TACTILE PAVING AT UNCONTROLLED CROSSINGS
- ROAD CROSS-SECTIONS
- EXISTING STREAMS; HAZELHATCH WATERCOURSE (EAST) SHANKEN STREAM (WEST)
- PROPOSED OVERGROUND DETENTION BASIN
- INFILTRATION TRENCH
- UNDERGROUND GEOCELLULAR ATTENUATION TANK
- PROPOSED RAIN GARDEN LOCATION
- PROPOSED STORM WATER CATCH-PIT
- PROPOSED SURFACE WATER BIO-SWALE
- PROPOSED SURFACE WATER 150# FILTER DRAIN
- PROPOSED BIO-RETENTION AREA WITH GRATED OUTLET
- TREE PIT
- ↘ SURFACE RUNOFF
- ↘ PROPOSED SURFACE WATER GULLY AND 150# COLLECTOR PIPE

rev	date	PLANNING SUBMISSION	ICJ	NOH
P01	09-06-22	PLANNING SUBMISSION	ICJ	NOH
rev	date	description	by	chkd.
A-		Approved		
B-		Approved with comments		
C-		Do not use		

client approval: **S4 - STAGE APPROVAL** issue purpose: **PLANNING**

DBFL Consulting Engineers
Civil, Structural & Transportation Engineering
www.dbfl.ie

DUBLIN OFFICE: Ormond House, Upper Ormond Quay, Dublin 7, D07 W704
PHONE: +353 1 450 4000
CORC OFFICE: Phoenix House, Monahan Road, Cork, T12 H1XV
PHONE: +353 (0) 21 2254538
WATERFORD OFFICE: Suite 10 The Arkun, Maritime Gate, Canada Street, Waterford, X91 W028
PHONE: +353 51 309 500

project ref: **BALLYOULSTER KDA SHD - PHASE 1 RESIDENTIAL DEVELOPMENT**

drawing title: **TYPICAL ARRANGEMENT FOR BRIDGE CROSSING NO.2 PLAN AND SECTION**

client: **KIERAN CURTIN, RECEIVER OVER CERTAIN ASSETS OF MAPLEWOOD DEVELOPMENTS UNLIMITED COMPANY**

designed by	author	scale	sheet size
NOH	ICJ	1:50	A1
drawing no.	revision		
180221-DBFL-RS-SP-DR-C-1152	P01		